



**TYPE:**

**TG1, TG3, TG6**

**REMOTE**

**EN** - Instructions and warnings for use

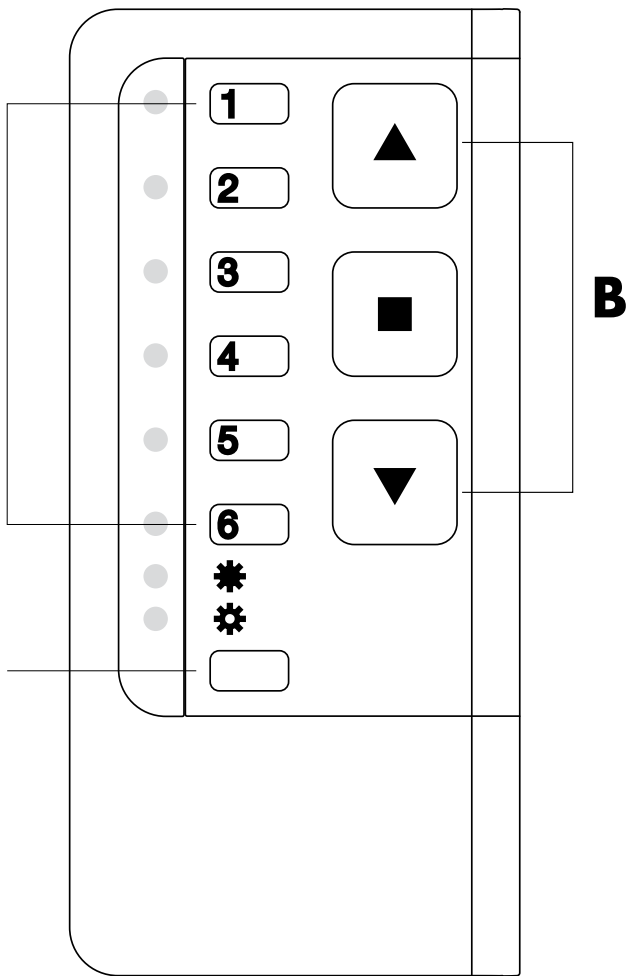
**1**

2

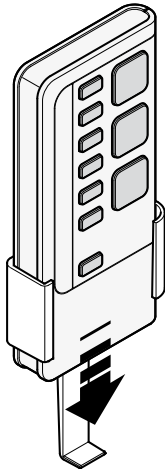
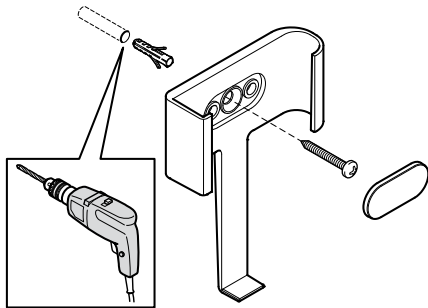

3

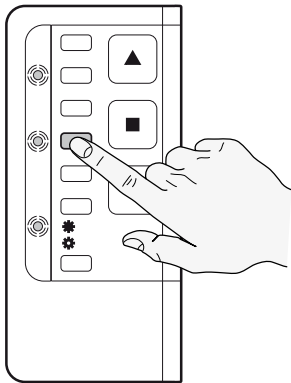
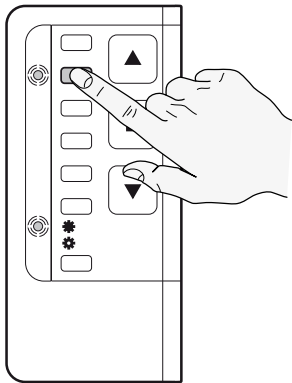

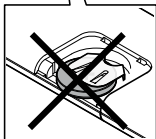
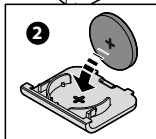
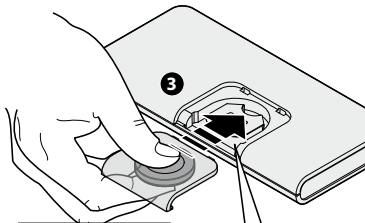
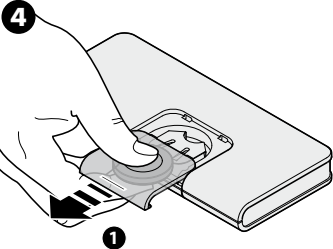

## **1 PRODUCT DESCRIPTION AND INTENDED USE**

This transmitter is part of the **TTGO remote** product range by TTGO. The transmitters in this range are designed to control automatic mechanisms on outdoor awnings, sun screens or shutters. **Any other use is unsuitable and prohibited!**

### **1.1 • Functional features**

- Available models have 1, 3 or 6 “groups” to which commands can be directed or have commands to manage the climate sensors.
  - **Fig. 1** shows all the keys that might be found on transmitters depending on the model:
- A** - “Group” keys (only on models with 3 or 6 groups): used to select the automation (or automations) to which commands are to be directed. To select the required group, press the corresponding key. When the corresponding LED is pressed, it lights up to show that the group has been activated.
- B** - Command keys: used to send **Up** (▲), **stop** (■) and **Down** (▼) commands.
- C** - Automatic command control keys (only models with sun key): this key enables (or disables) the motor’s reception of automatic commands transmitted by any climate sensors in the installation.
- Supplied with a wall support for the transmitter (**fig. 2**).

## **2 OPERATION OF THE TRANSMITTER**

### **2.1 • Control of the transmitter**

Before memorising the transmitter in the motor receiver, ensure that it is working correctly by pressing any key while observing the LED light up (**fig. 1**); if the LED does not light up, read paragraph 3 “Replacing the battery”.

### **2.2 • Transmitter functions**

**group** = the automations associated with the transmitter to which the command is directed

- **Select a “group” to which a command is to be sent**

**(only models with 3 or 6 groups)**

With these transmitter models, before sending a command, the user should select the “**group**” (i.e. the automations associated with the transmitter) to which the command is to be sent by pressing the required key (**fig. 1**).

After selecting the group, the corresponding LED stays lit for a few seconds and, before it goes off, other groups can be selected to be added to the first group selected (to eliminate a group selected by mistake, switch of the corresponding LED by pressing the associated key). After the required groups have been selected, when the corresponding LEDs switch off automatically, the groups will remain in the transmitter’s memory until a new group (or several groups) is selected. While they remain in the memory, commands can be sent to them without first having to select them.

- **Enable or disable reception of the automatic commands sent by a climate sensor (only for models with the sun function)**

With these transmitter models, the user can enable or disable reception of automatic commands from climate sensors connected to the automation (e.g. the “Sun” automation). In this case, for better management of commands, use a single transmitter with keys to enable or disable automatic commands.

**Only for models with “Sun” function with 3 or 6 groups:** in these transmitters, before enabling or disabling the function, select the “**group**” (or groups) to which the setting is directed.

When the key is pressed, the system displays the current setting. Pressing again changes the automatic function of the automation. The “Wind” sensor cannot be disabled as it protects the automation itself from the wind. When the automatic function is enabled, the user can send manual commands at any time. For more information, see the automation system or climate sensor manuals.

While using these transmitters, to check whether the “groups” are enabled or disabled, select the required “groups” one at a time and observe the LED (**fig. 3**).

### **2.3 • Memorising the transmitter**

- To memorise the transmitter in a control unit or a receiver, the user can choose one of the following procedures, depending on which is available in the manual of the control unit or the receiver:

**- Memorising the first Transmitter**

**- Memorising a new transmitter via an already memorised transmitter**

Detailed instructions of each procedure are

available in the instructions manual of the motor or control unit with which the transmitter is to be associated.

### **3 REPLACING THE BATTERY**

When the batteries are discharged, the capacity of the transmitter is significantly reduced. Specifically, when a key is pressed, there is a delay before the corresponding LED lights up (= battery almost discharged) or the intensity of the LED light fades (= battery totally discharged). In these cases, to restore normal transmitter operation, replace the battery with a version of the same type noting the polarity (**fig. 4**).

#### • **Disposal of batteries**

**Caution!** – Discharged batteries contain pollutant substances and therefore must never be disposed of as normal waste. Dispose of observing waste separation and collection procedures as required by local regulations.

### **4 DISPOSAL OF THE PRODUCT**

This product is an integral part of the automation system it controls and must be disposed of alongside it. As with installation operations, disposal operations must be performed by qualified personnel at the end of the product's useful life. This product is made of various types of materials, some of which can be recycled while others must be scrapped. Seek information on the recycling and disposal systems required by local regulations in your area for this product category.

**Caution!** Some parts of the product may contain pollutants or hazardous substances which, if released into the environment, may cause serious damage to the environment or human health.

As indicated by the symbol on the side, disposal of this product as domestic waste is strictly prohibited.

Separate waste into categories for disposal, according to the methods established by local regulations, or return the product to the retailer when purchasing a new version.

**Caution!** - Local regulations may impose serious fines in the event of improper disposal of this product.

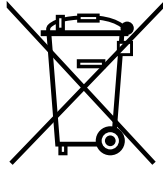

### **5 TECHNICAL SPECIFICATIONS OF PRODUCT**

■ **Power supply:** 1 alkaline CR2032 battery, 3 V DC

■ **Frequency:** 433.92 MHz ( $\pm 100$  kHz)

■ **Radiated power:** approx. 1 mW (ERP)

■ **Radio encoding:** Shark1

■ **Operating temperature:** -5°C; +55°C

■ **Capacity (\*)**: approx. 200 m (in the open); 35 m (inside buildings)

■ **Protection rating:** IP 40 (suitable for use indoors or in protected environments)

■ **Dimensions:** 51 x 102 x 16 mm

■ **Weight:** 40 g

**N.B.:** (\*) The capacity of transmitters and the reception capacity of receivers is strongly affected by other devices (e.g. alarms, headphones, etc.) operating on the same frequency in your area. In these cases, the manufacturer cannot provide any guarantee regarding the actual range of its devices. • All technical specifications stated herein refer to an ambient temperature of 20° C ( $\pm 5^\circ$  C). • The manufacturer reserves the right to make changes to products at any time when deemed necessary, maintaining the same intended use and functionality.

### **6 CE DECLARATION OF CONFORMITY**

Declaration number: 489/TG.

Nice S.p.A. hereby declares that the products: TG1, TG3, TG6, TG1S, TG3S, TG6S comply with the essential requirements and other relevant provisions laid down by Directives 1999/5/CE (applicable only to products with on-board receiver).

The EC declaration of conformity can be viewed and printed from the [www.nice-service.com](http://www.nice-service.com) website or requested from Nice S.p.A.

8 October 2013

Mauro Sordini (Chief Executive Officer)